

Z

**Z5801/Z5804/Z5807
Z5802/Z5805/Z5808**

Mounting instructions 1.1 en

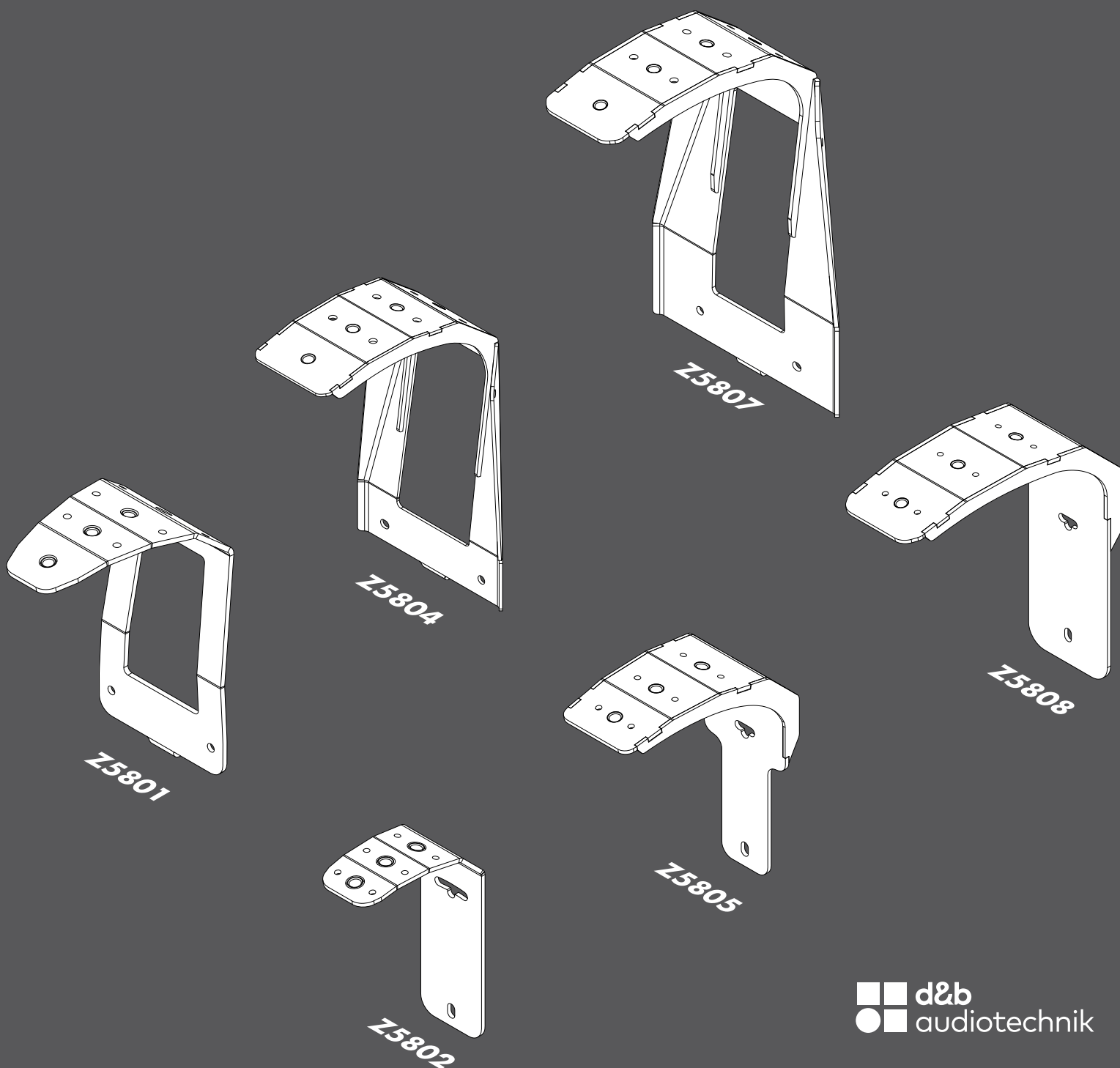

Notes on document version

Version 1.1:

Initial edition.

General information

Z5801/Z5804/Z5807

Z5802/Z5805/Z5808 Mounting instructions

Version: 1.1 en, 01/2026, D2793.EN .01

Copyright © 2026 by d&b audiotechnik GmbH & Co. KG; all rights reserved.

Keep this document with the product or in a safe place so that it is available for future reference.

We recommend you to regularly check the d&b website for the latest version of this document.

When reselling this product, hand over this document to the new owner.

d&b audiotechnik GmbH & Co. KG
Eugen-Adolff-Str. 134, D-71522 Backnang, Germany
T +49-7191-9669-0, F +49-7191-95 00 00
docadmin@dbaudio.com, www.dbaudio.com

- 1 d&b U-Series Vertical and Horizontal brackets..... 4**
 - 1.1 Intended use..... 4
 - 1.2 Safety precautions..... 4
- 2 d&b Z5801/Z5804/Z5807 Vertical brackets..... 5**
 - 2.1 Scope of supply and weights..... 5
 - 2.2 Mounting options..... 5
 - 2.3 Assembly..... 6
- 3 d&b Z5802/Z5805/Z5808 Horizontal brackets..... 7**
 - 3.1 Scope of supply and weights..... 7
 - 3.2 Mounting options..... 7
 - 3.3 Assembly..... 8
- 4 Manufacturer's declarations..... 9**
 - 4.1 Conformity of rigging components..... 9
 - 4.2 Disposal..... 9

1 d&b U-Series Vertical and Horizontal brackets

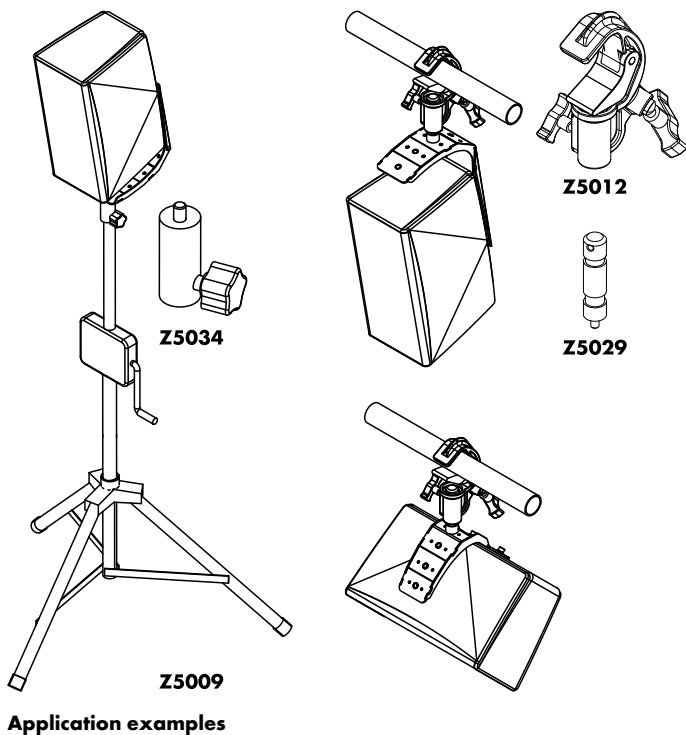

1.1 Intended use

Pre notes:

Throughout these mounting instructions, the application and assembly procedure are exemplarily shown and described for the U5 loudspeaker. Same applications and assembly procedures also applies to U3 and U7 as well as to U3N, U5N and U7N loudspeakers.

The U-Series Vertical and Horizontal brackets are intended for deploying a single U-Series loudspeaker on a standard loudspeaker high stand or for flying it from bars and trusses. The brackets must only be used as described in these mounting instructions.

For this purpose, the following d&b rigging accessories or equivalent components can be used:

- d&b Z5009 Loudspeaker stand with winder
- d&b Z5013 Pole with winder M20
- d&b Z5034 Loudspeaker stand adapter M10
- d&b Z5029 TV spigot M10
- d&b Z5012 Pipe clamp

1.2 Safety precautions

General safety

- Installation and setup should only be carried out by qualified and authorized personnel observing the valid national Rules for the Prevention of Accidents (RPA).
- It is the responsibility of the person installing the assembly to ensure that the suspension/fixing points are suitable for the intended use.
- Always carry out a visual and functional inspection of the items before use. In case there is any doubt as to the proper functioning and safety of the items, these must be withdrawn from use immediately.

Load safety information

NOTICE!

The U-Series Vertical and Horizontal brackets are designed to carry the weight of a single U-Series cabinet either deployed on a standard loudspeaker high stand or flown from bars or trusses.

The brackets must only be used in an upright position or suspended vertically, as shown in the graphic opposite.

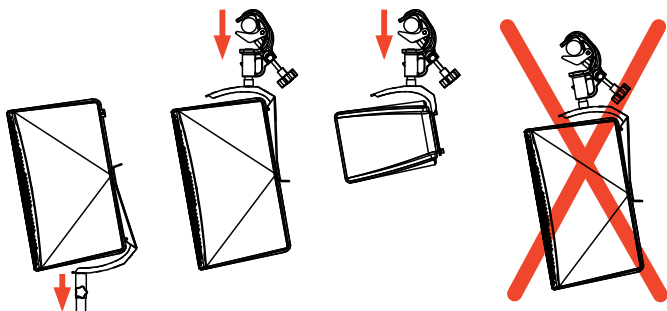

2 d&b Z5801/Z5804/Z5807 Vertical brackets

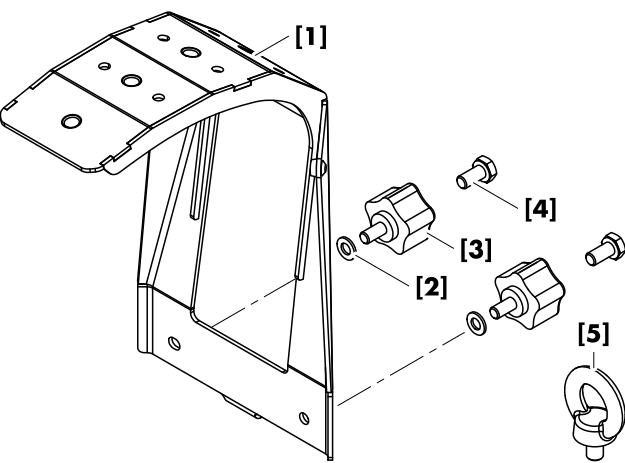

Scope of supply
Shown as an example: Z5804

- [3] Hand bolt: Intended for mobile applications
- [4] Hex head bolt: Intended for fixed installations

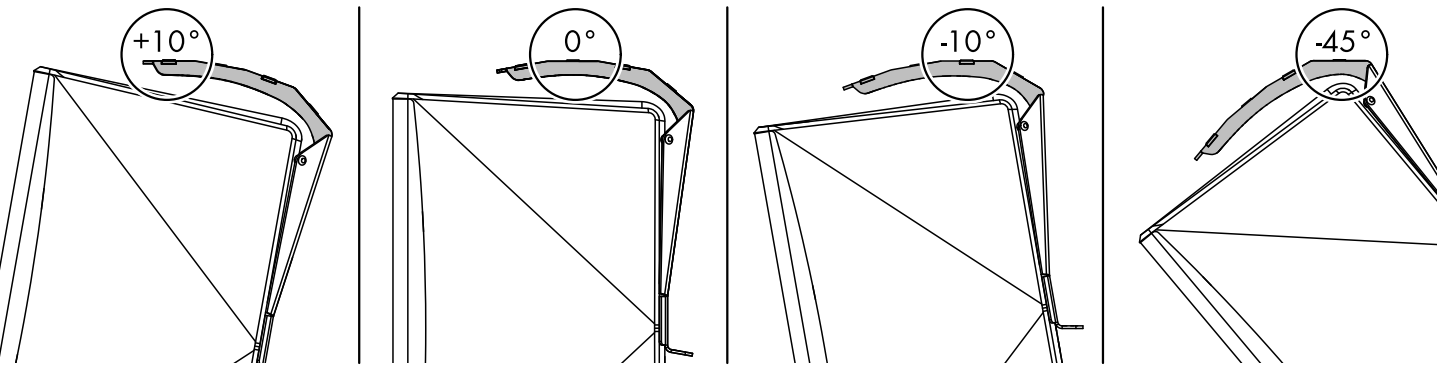
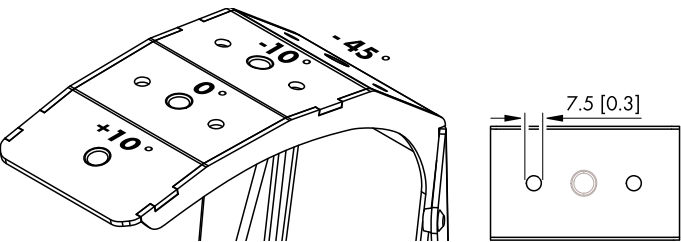

2.1 Scope of supply and weights

Please verify the shipment for completeness and proper condition of the items.

Pos.	Qty.	d&b Code	Description
[1]	1	▪ Z5801 ▪ Z5804 ▪ Z5807	U3/U3N Vertical bracket U5/U5N Vertical bracket U7/U7N Vertical bracket
Including:			
[2]	2	Q5005.001.00	U-washer 8.4
[3]	2	Q9049.40.825	Hand bolt M8 x 16
[4]	2	Q3039.003.00	Hex head bolt M8 x 16
[5]		Q9031	Safety eye bolt M8
	1	D2793.EN .01	Mounting instructions

Weights	
Z5801	1.5 kg (3.3 lb)
Z5804	1.5 kg (3.3 lb)
Z5807	2.8 kg (6.2 lb)

2.2 Mounting options

The top (comb) of the bracket is equipped with a total of four threaded inserts M10, which allow the loudspeaker cabinet to be set to dedicated tilt angles (up or down tilt), as shown in the graphics below.

In addition to the 0°, -10°, and -45° threaded inserts, two 7.5 mm [0.3"] holes are provided to allow the bracket to be mounted directly to ceilings or other suitable surfaces using adequate fixing screws and anchors (⇒ not enclosed).

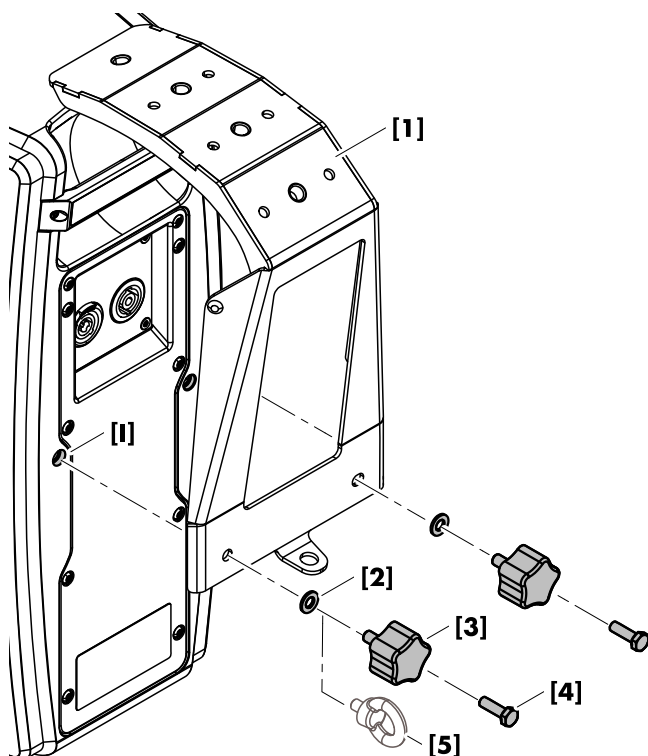

2.3 Assembly

NOTICE!

Only use the supplied and specified screws, otherwise there is a risk of damaging the threaded inserts of the cabinet.

At the center rear of the cabinet, two corresponding M8 threaded inserts [1] are provided for the attachment of the bracket.

1. At the rear, attach the bracket [1] to the cabinet's threaded inserts [1], as shown in the graphic opposite.
2. Insert the hand bolts [3] together with the U-washers [2] and hand-tighten the screws.
 - ↳ For fixed installations, the hex head screws [4] can be used alternatively.
 - ⇒ Tool required: Torque wrench #13 mm.
3. If a secondary safety device needs to be attached, use the enclosed safety eye bolt [5] instead of one of the hand bolts [3] or hex head screws [4].

3 d&b Z5802/Z5805/Z5808 Horizontal brackets

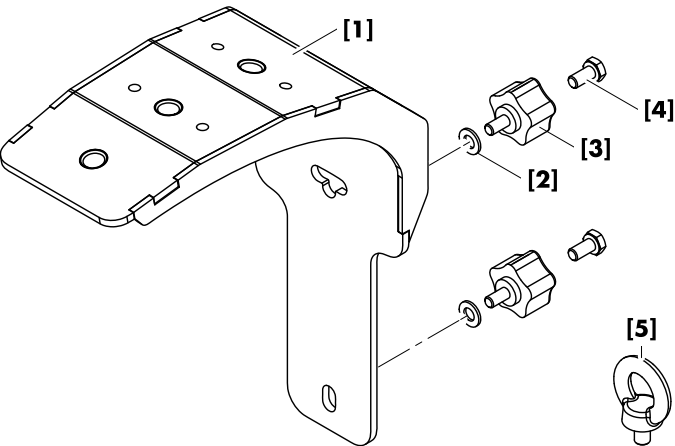

Scope of supply
Shown as an example: Z5805

- [3] Hand bolt: Intended for mobile applications
- [4] Hex head bolt: Intended for fixed installations

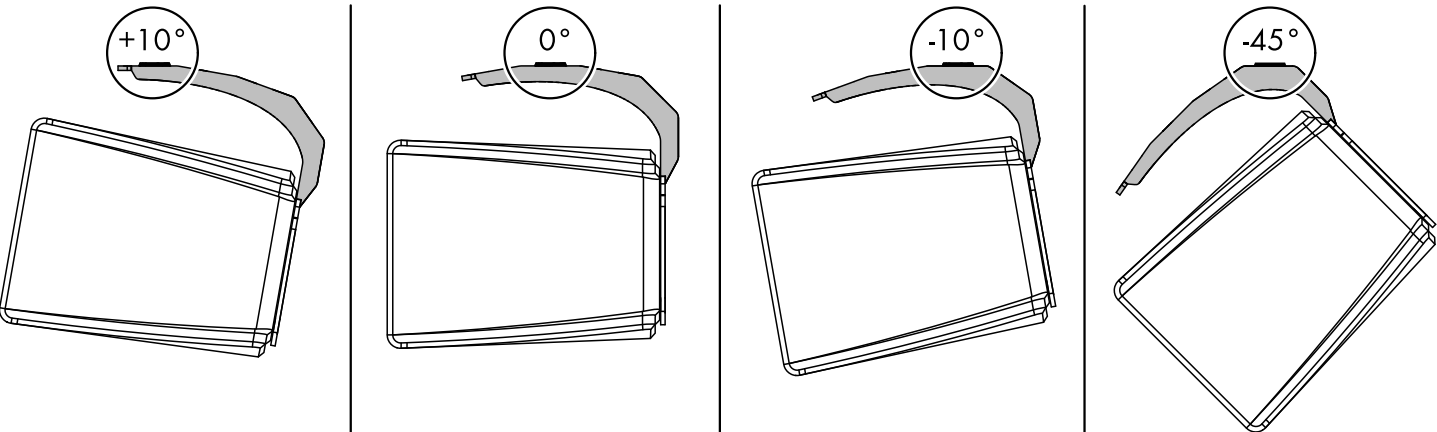
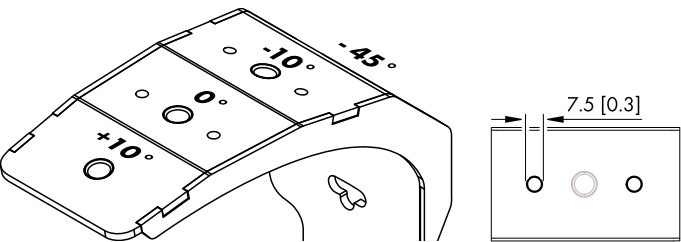

3.1 Scope of supply and weights

Please verify the shipment for completeness and proper condition of the items.

Pos.	Qty.	d&b Code	Description
[1]	1	▪ Z5802 ▪ Z5805 ▪ Z5808	U3/U3N Horizontal bracket U5/U5N Horizontal bracket U7/U7N Horizontal bracket
Including:			
[2]	2	Q5005.001.00	U-washer 8.4
[3]	2	Q9049.40.825	Hand bolt M8 x 16
[4]	2	Q3039.003.00	Hex head bolt M8 x 16
[5]		Q9031	Safety eye bolt M8
	1	D2793.EN .01	Mounting instructions

Weights	
Z5802	1 kg (2.2 lb)
Z5805	1.2 kg (2.6 lb)
Z5808	1.8 kg (4 lb)

3.2 Mounting options

The top (comb) of the bracket is equipped with a total of four threaded inserts M10, which allow the loudspeaker cabinet to be set to dedicated tilt angles (up or down tilt), as shown in the graphics below.

In addition to the 0°, -10°, and -45° threaded inserts, two 7.5 mm [0.3"] holes are provided to allow the bracket to be mounted directly to ceilings or other suitable surfaces using adequate fixing screws and anchors (⇒ not enclosed).

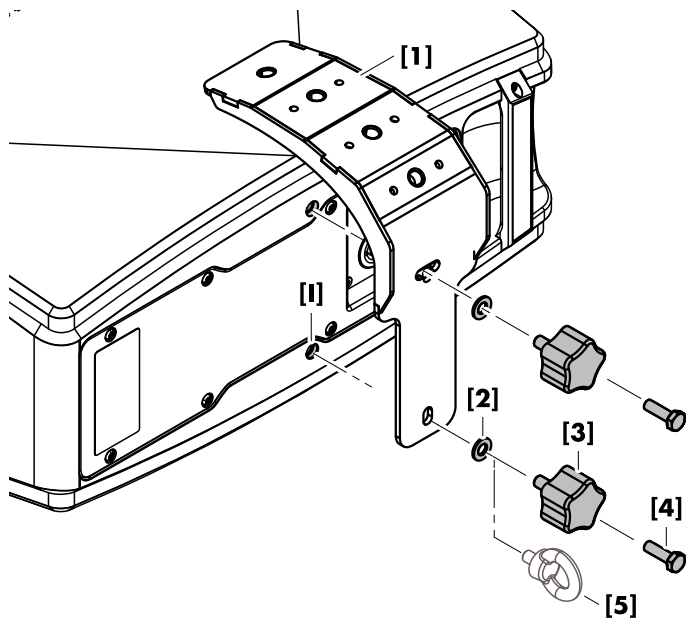

3.3 Assembly

NOTICE!

Only use the supplied and specified screws, otherwise there is a risk of damaging the threaded inserts of the cabinet.

At the center rear of the cabinet, two corresponding M8 threaded inserts [1] are provided for the attachment of the bracket.

1. At the rear, attach the bracket [1] to the cabinet's threaded inserts [1], as shown in the graphic opposite.
2. Insert the hand bolts [3] together with the U-washers [2] and hand-tighten the screws.
 - ↳ For fixed installations, the hex head screws [4] can be used alternatively.
 - ⇒ Tool required: Torque wrench #13 mm.
3. If a secondary safety device needs to be attached, use the enclosed safety eye bolt [5] instead of one of the hand bolts [3] or hex head screws [4].



4.1 Conformity of rigging components

This declaration applies to:

- **d&b Z5801/Z5804/Z5807** U-Series Vertical bracket
- **d&b Z5802/Z5805/Z5808** U-Series Horizontal bracket

by d&b audiotechnik GmbH & Co. KG.

All product variants are included, provided they correspond to the original technical version and have not been subject to any later design or electromechanical modifications.

We herewith declare that said products are in conformity with the provisions of the respective directives including all applicable amendments.

Detailed and applicable declarations are available on request and can be ordered from d&b or downloaded from the d&b website at www.dbaudio.com.

WEEE-Reg.-Nr. DE: 13421928

4.2 Disposal

When out of use, the rigging components must be disposed of in accordance with the national environmental regulations.

Ensure that damaged rigging components are disposed of in a way that they cannot be used again.



